

# Zurcon® Scraper WNE



---

Single-acting

---

Dynamic + Static Sealing Lip

**Material:**

Zurcon®

---







## ■ Zurcon® Scraper WNE



### ■ Description

These scrapers are manufactured in polyurethane. The static sealing lip ensures against the intrusion of dirt and fluids over the outer diameter.

The scraper WNE has an interference to the groove outside diameter.

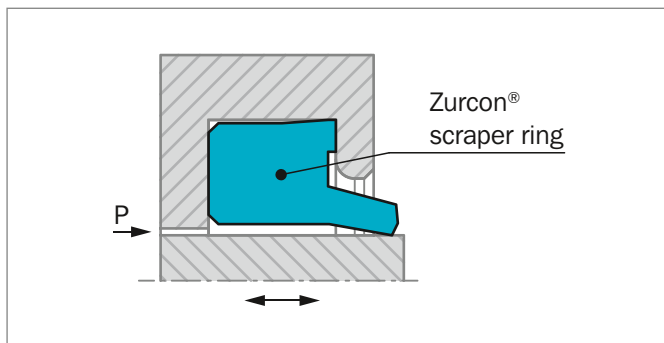

Figure 207: Scraper WNE

### ADVANTAGES

- High wear resistance
- Good prevention against external fluid intrusion
- Easy installation
- Space-saving construction

### APPLICATION EXAMPLES

These scrapers are recommended wherever there are dusty and humid conditions and especially for the following applications:

- Mobile hydraulic machinery
- Agriculture machinery

### OPERATING CONDITIONS

<b>Speed:</b>	Up to 1 m/s
<b>Temperature:</b>	-35 °C to +100 °C
<b>Media:</b>	Mineral oil based hydraulic fluids
<b>Groove Type:</b>	Closed

### IMPORTANT NOTE

The above data are maximum values and cannot be used at the same time, e.g. the maximum operating speed depends on material type, pressure, temperature and gap value. Temperature range also depends on media.

### MATERIALS

Zurcon® Polyurethane:	92 Shore A
Material code:	Z201
Color:	Turquoise



## Installation Recommendation

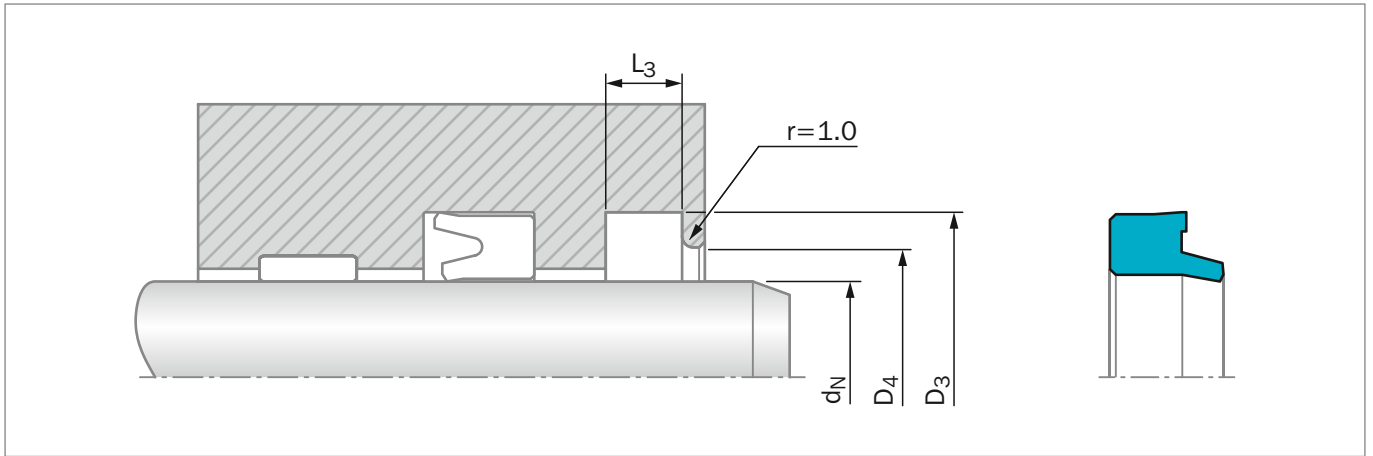

Figure 208: Installation Drawing

### ORDERING EXAMPLE

For WNE scrapers

<b>Rod Diameter:</b>	$d_N = 45 \text{ mm}$
<b>Groove Diameter:</b>	$D_3 = 53.6 \text{ mm}$
<b>TSS Part No.:</b>	WNE000450 from Table 190
<b>Material Code:</b>	Z201

<b>TSS Article No.</b>	<b>WNE0 0 0450 - Z201</b>
TSS Series No.	WNE0
Type (Standard)	0
Rod Diameter x 10	0450
Quality Index (Standard)	-
Material Code	Z201

Table 190: Installation Dimensions / TSS Part No.

Rod Diameter	Groove Diameter	Groove Width	Bore Diameter	TSS Part No.
$d_N$ h9	$D_3$ H11	$L_3$ +0.2	$D_4$ +0.2	
8.0	14.6	3.8	11.0	WNE000080
10.0	16.6	3.8	13.0	WNE000100
12.0	18.6	3.8	15.0	WNE000120
14.0	20.6	3.8	17.0	WNE000140
15.0	21.6	3.8	18.0	WNE000150
16.0	22.6	3.8	19.0	WNE000160
18.0	24.6	3.8	21.0	WNE000180
20.0	28.6	5.3	23.0	WNE000200
22.0	30.6	5.3	25.0	WNE000220
24.0	32.6	5.3	27.0	WNE000240
25.0	33.6	5.3	28.0	WNE000250
28.0	36.6	5.3	31.0	WNE000280
30.0	38.0	5.3	33.0	WNE000300
30.0	38.6	5.3	33.0	WNE100300



Rod Diameter	Groove Diameter	Groove Width	Bore Diameter	TSS Part No.
$d_N$ h9	$D_3$ H11	$L_3$ +0.2	$D_4$ +0.2	
32.0	40.6	5.3	35.0	WNE000320
35.0	43.0	5.3	38.0	WNE000350
35.0	43.6	5.3	38.0	WNE100350
36.0	44.6	5.3	39.0	WNE000360
38.0	46.6	5.3	41.0	WNE000380
40.0	48.6	5.3	43.0	WNE000400
45.0	53.6	5.3	48.0	WNE000450
46.0	54.6	5.3	49.0	WNE000460
50.0	58.6	5.3	53.0	WNE000500
50.0	58.0	5.3	53.0	WNE100500
55.0	63.6	5.3	58.0	WNE000550
56.0	64.6	5.3	59.0	WNE000560
60.0	68.6	5.3	63.0	WNE200600
61.0	69.6	5.3	64.0	WNE000610
63.0	71.6	5.3	66.0	WNE000630
65.0	73.6	5.3	68.0	WNE000650
70.0	78.6	5.3	73.0	WNE100700
75.0	83.6	5.3	78.0	WNE000750
80.0	88.6	5.3	83.0	WNE000800
85.0	97.2	7.1	91.0	WNE000850
90.0	102.2	7.1	96.0	WNE000900
95.0	107.2	7.1	101.0	WNE000950
100.0	112.2	7.1	106.0	WNE101000
110.0	122.2	7.1	116.0	WNE001100
120.0	132.0	7.1	126.0	WNE001200
125.0	137.2	7.1	131.0	WNE001250
135.0	147.2	7.1	141.0	WNE001350
140.0	152.2	7.1	146.0	WNE001400
160.0	175.2	10.1	168.0	WNE101600
180.0	195.2	10.1	188.0	WNE001800
200.0	215.2	10.1	208.0	WNE002000

---

! This page is intentionally left blank.